

# SETTING UP EDUROAM

**STEP 1:** Just like when you connect with „KLU“, open the WiFi Menu first.

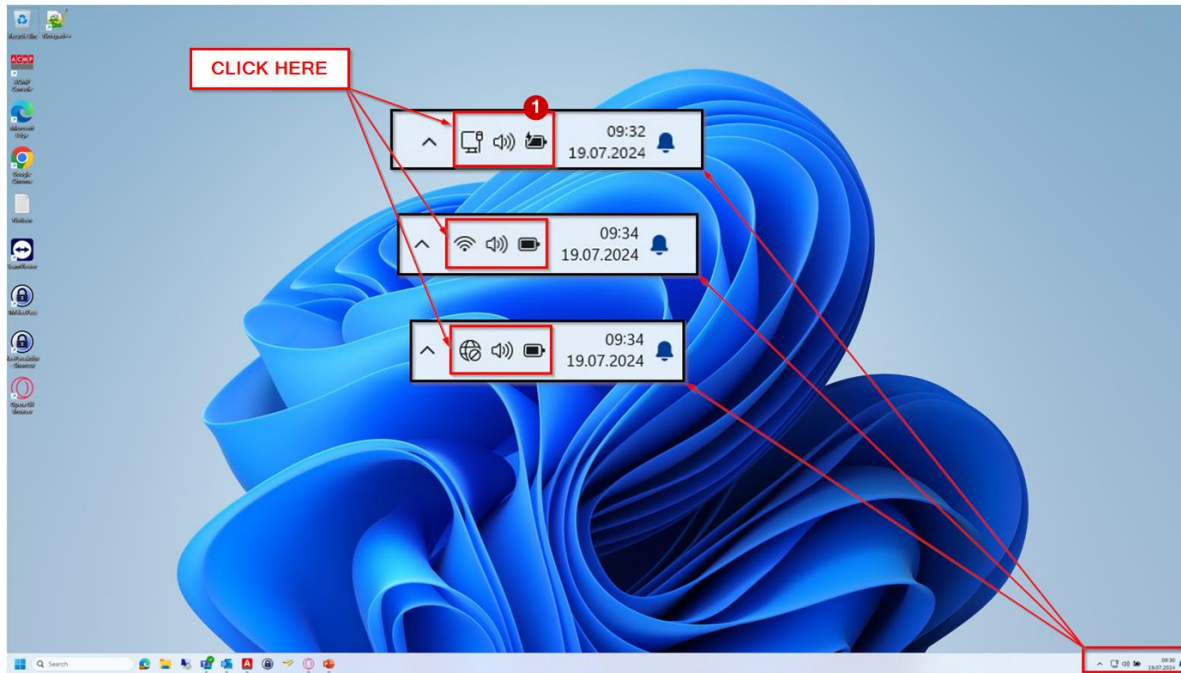

Navigating to the WiFi Menu (Windows)

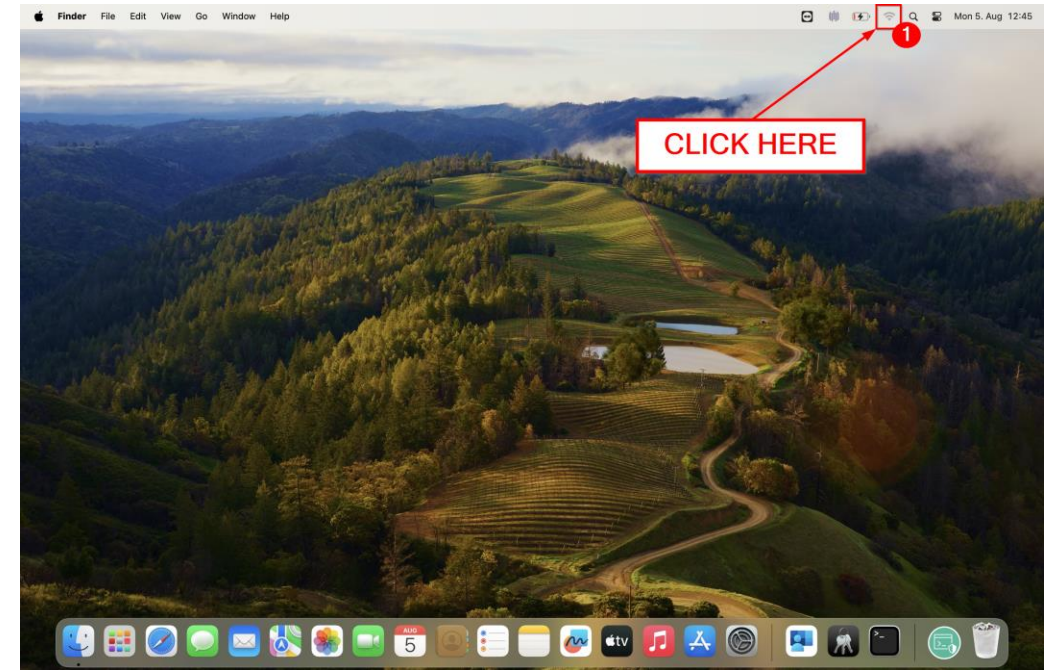

Navigating to the WiFi Menu (Mac)

# SETTING UP EDUROAM

**STEP 2:** Manage your WiFi connections. Choose „eduroam“ and click „Connect“. We recommend ticking the checkbox „Connect automatically“ before connecting.

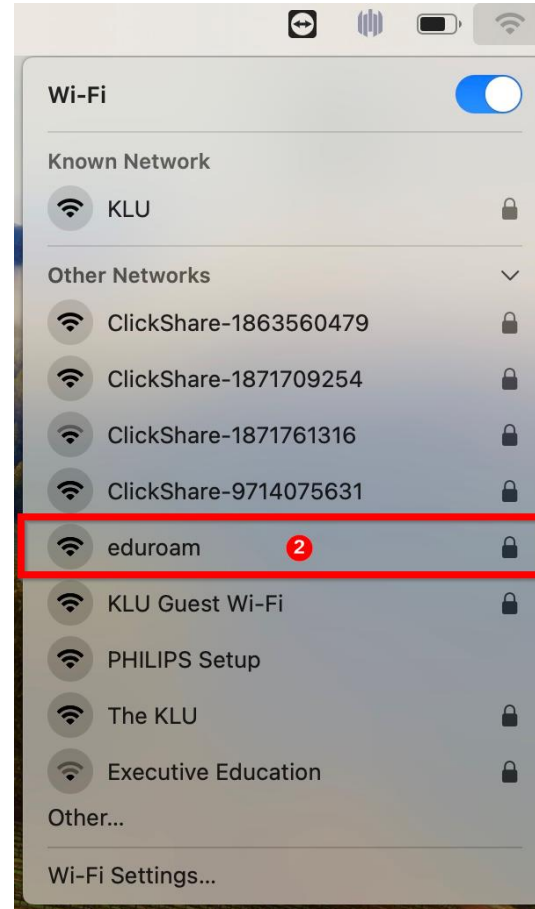
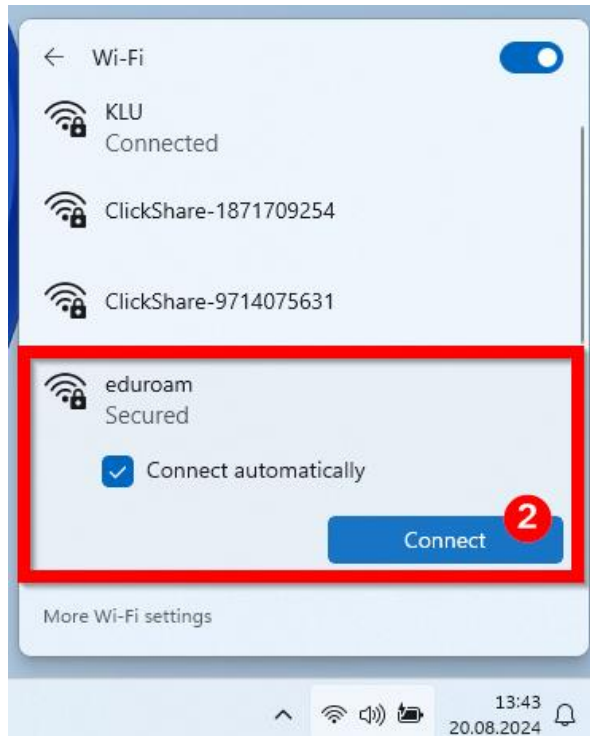

**Note:** Your login credentials are the same as your „KLU“ login credentials. (Firstname.Lastname@the-klu.org)

# SETTING UP EDUROAM

## STEP 3:

- **For Windows:** Confirm your intention to connect with „eduroam“ and enter your login details in the next window.

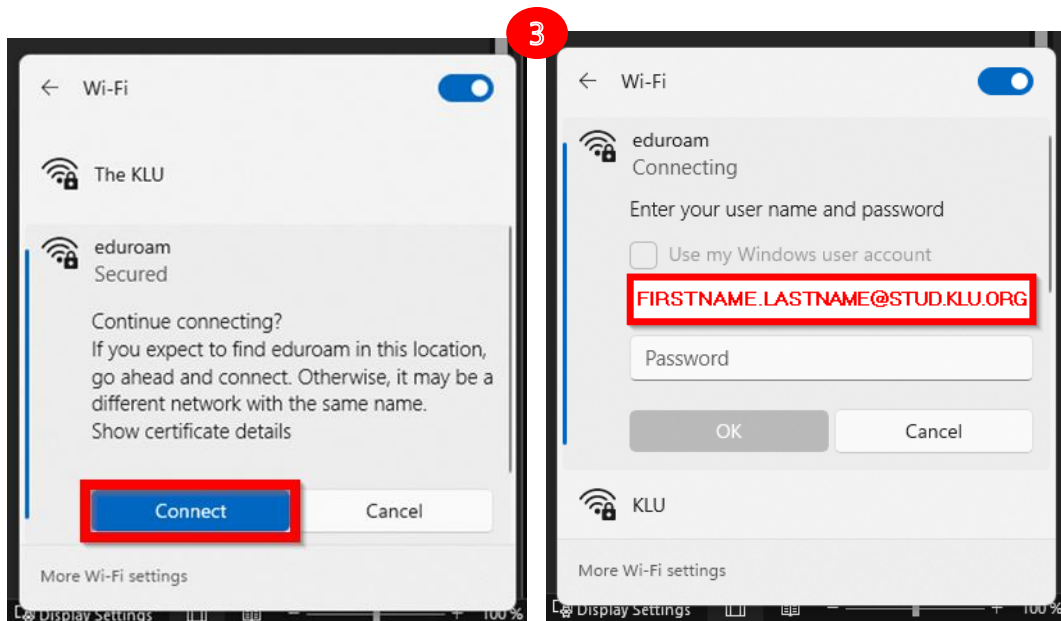

- **For Mac:** Enter your login details. (Tick the checkbox „Remember this information“ beforehand)

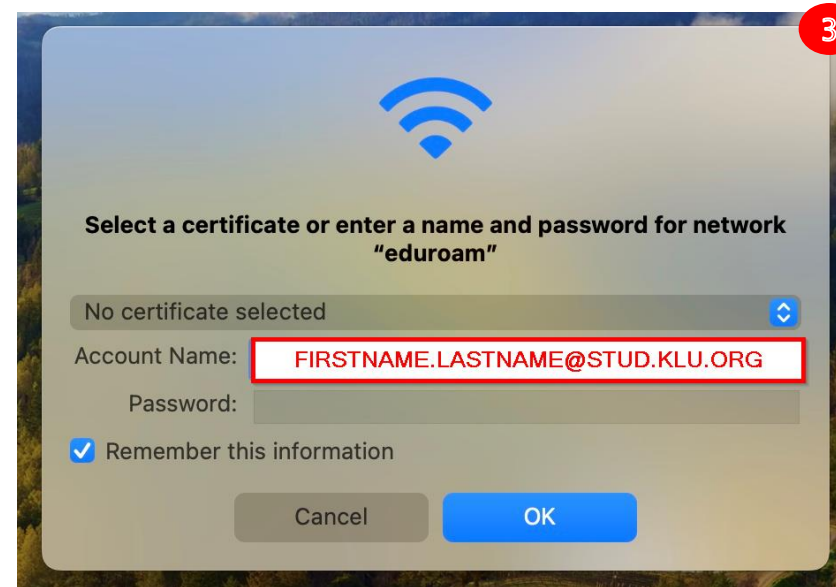

**Note:** Your login details were sent to your private E-Mail address beforehand.

# SETTING UP EDUROAM

## STEP 4:

**Windows:** Once again you will be asked if you want to continue connecting. Proceed by clicking „Connect“ one last time.

**Mac:** There should be no problem with the certificate. Proceed by clicking „Continue“.

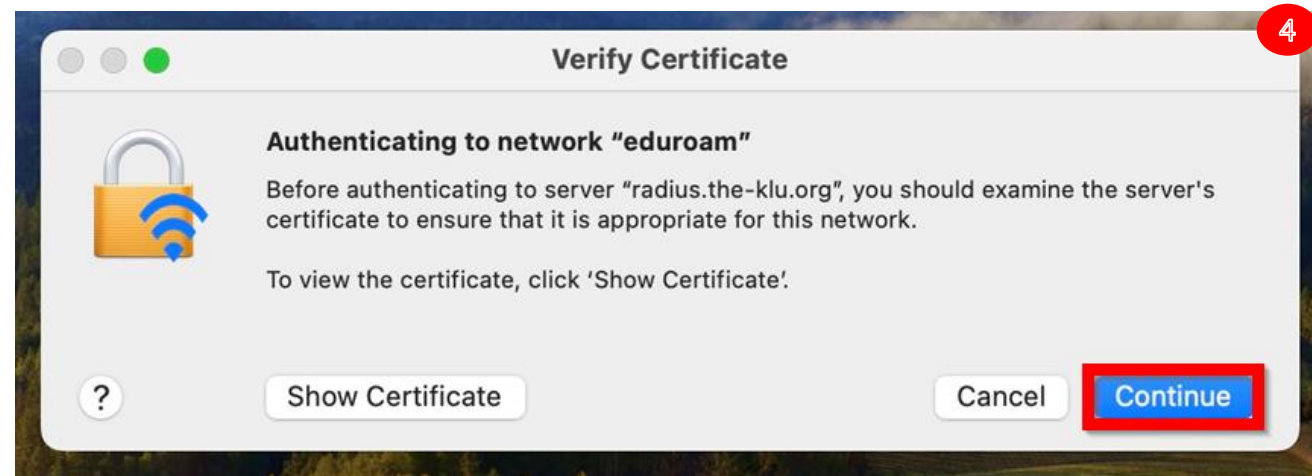
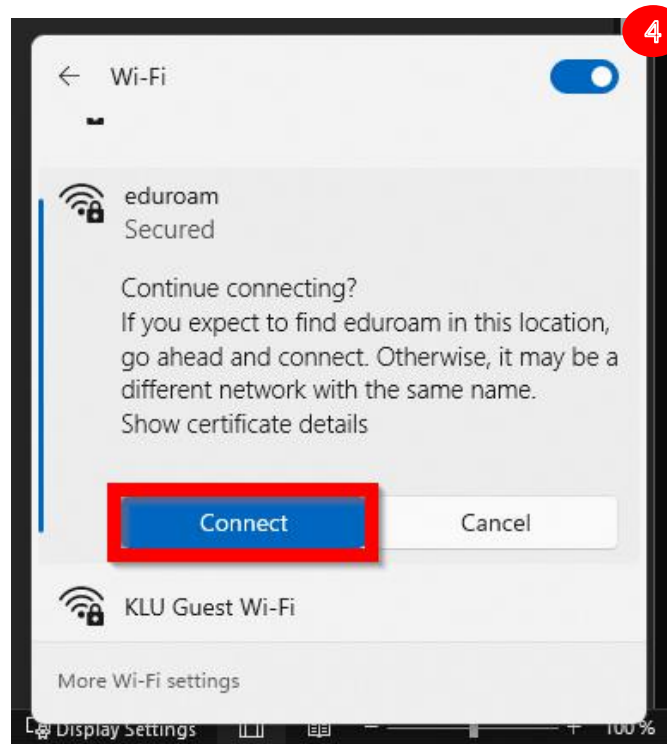

# SETTING UP EDUROAM

**STEP 5:** The following screenshots underneath show how a successful connection to eduroam would look like.

If you're having trouble connecting to eduroam please contact us via [servicedesk@klu.org](mailto:servicedesk@klu.org)

